



Kirra

built by **apollo**



6 BERTH OPTION ALSO AVAILABLE - LIGHT RIGID LICENSE ONLY

VEHICLE

IVECO Daily MY20 50C18A8
8 speed full automatic transmission
3 litre - 4 cylinder engine (euro 6)
Variable geometry turbocharger & intercooler
Max Power: 180hp/134kw @ 2900-3500rpm
Max Torque: 430Nm @ 1500-2600rpm
Fuel Tank: 100 litres (diesel)

CONSTRUCTION

Finish - Gel-coated interior and exterior walls
Roof & walls - Single piece structural composite panel
Floor - Single piece structural composite panel
Composite panels - Insulative foam core
Windows - Double glazed acrylic

APPLIANCES

Air conditioner, 2.4kW reverse cycle roof top
Cooktop with grill & oven (1 electric / 2 gas)
Fridge 188L absorption (12V / 240V / Gas)
Water Heater 14L (Gas / 240V)
Microwave 25L

POWER & ELECTRICS

Reversing camera with interior mirror display
House battery 1x 100Ah deep cycle, fully sealed
Battery charger 25amp, 12volt 7 stage
Solar, 1x 180W panel with regulator
Stereo Player with Bluetooth connectivity
Power inlet & outlet 240V
Power outlet 12volt & USB charge outlet

EXTERNAL FEATURES

Awning, 4.0m (13') windout cassette style
Antenna, King Jack directional over-the-air HDTV
Gas cylinder, 2x 9kg
BBQ gas bayonet fitting
Entry door, secure 4 point locking and safety mesh
Roof hatch to rear dinette with day/night blind
Roof hatches with 12V fan to shower & ensuite
Entry grab rail with LED illumination
Storage locker, tunnel boot
Decals, 'Kirra' stylised design

KITCHEN & PLUMBING

Fresh water, 90 litre storage
Grey water, 90 litre storage
Water level monitor
Shower external, hot & cold supply
Pressurised town water connection
Kitchen sink, stainless steel with flickmixer
Laminated plywood benchtops
Kitchen cabinets and drawers

LIVING AREA

Front cafe style dinette
Rear club lounge with electric drop down bed above
Television, 22" (55cm) 12V HD DVD/TV (rear dinette)

ENSUITE

Vanity with hand basin & flickmixer
Mirrored cabinet to wall above vanity
Fully enclosed shower, one piece fibreglass
Swivel cassette toilet 18L with electric flush



WINNEBAGO

Kirra specifications



DAYTIME LAYOUT

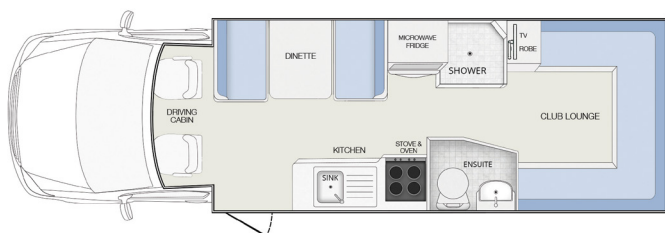

NIGHTTIME LAYOUT

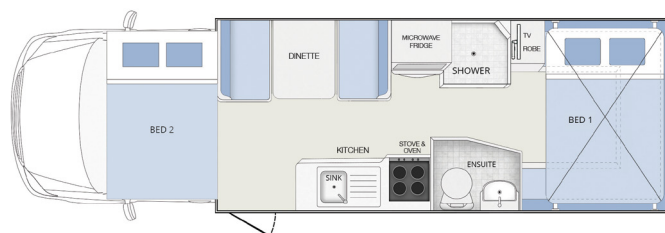

EXTERNAL DIMENSIONS

OA Length (mm)	7906 (25'11")
OA Width (mm) excl mirrors	2450 (8'0")
OA Height - low luton (mm)	n/a
OA Height - high luton (mm)	3151 (10'4")
GVM Weight (kg)	4495 or 5200
Payload (kg)	645 or 1350

INTERNAL DIMENSIONS

Floor Plan Length (mm)	5295 (17'4")
Floor Plan Width (mm)	2260 (7'5")
Ceiling Height (mm)	2040 (6'8")
Bed 1 (cm) electric bed lift**	190x134
Bed 2 (cm) over drivers cabin	225x135

**Electric Bed Lift - 270kg load limit static
*Weights & measurements are indicative only



OPTIONAL EXTRAS

The addition of any options or accessories to this vehicle may require the amount of seatbelts to be reduced or the vehicle to become rated as light rigid (5.2tonne)

- Battery, additional 100Ah deep cycle battery
- Battery, 1x 100Ah Lithium battery + charger
- Concertina door to divide living areas
- Diesel heater, Webasto 2kW
- Dinette, Burleigh café style with 4x seatbelts
- Fridge, Dometic RUC 6408X 188L compressor
- Iveco, Engine Upgrade to 210hp/156kW
- Inverter, Projecta Pure Sine Wave 1000W
- Nudge bar chrome
- Towbar, 3 tonne (max towball varies with options selected)
- Upholstery, drivers cab seats to match soft furnishings
- Water filter to kitchen sink
- Water, Fresh - additional 100 or 50 litres
- Water, Grey - additional 50 litres

Note: Appliances may vary depending on availability. Not all items may be listed in this publication. Specifications are subject to change due to continuous product improvements.